

Product Manual

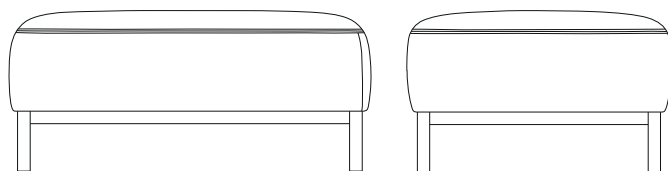

Caro Pouf Series Designed by kaschkasch

Version 1.0 - January/2023

Bolia.com

Vaerkmestergade 11-13
8000 Aarhus C, Denmark
+45 51 50 51 22

EN

Read the product manual carefully before using your product. If you do not follow the instructions, there is a risk that you could damage the product or in the worst case cause injury. Keep the product manual for future reference. If the product is later passed on to third parties, this manual must also be provided.



This symbol indicates a warning regarding the care, handling, or use of the product. If such a warning is not followed, there is a risk that you could damage the product, or in the worst case cause injury.

Use the product only for the purpose described in this manual. Any other use does not correspond to the intended purpose of the product and can lead to damage to the product or injuries. The manufacturer or dealer accepts no responsibility for damage resulting from the use of the product in a manner for which it is not intended. Incorrect, improper use of the product can lead to personal injuries. Children must not play with the packaging film, as there is a risk that they will be wrapped up in it and caught. Before using the product, make sure that there is nothing that can harm or injure people.

Risk of damaging the product

Incorrect, improper use, handling and cleaning can damage parts or the entire product.

Do not step on or jump on the product. It is not intended for this.

Do not use a hard brush, solvent, corrosive or strong cleaning agent to clean the products, if not advised by Bolia.com.

Always use recommended care and cleaning products.

Never cover wet products. If a wet product is covered, it can be damaged.

Further information can be found on our website: Bolia.com

Technical information

As we are constantly developing and improving our products, design and technical changes may occur. This products manual can be downloaded as a PDF file from our website: Bolia.com



Disposal of packaging & product

Dispose of the product and packaging in accordance with local waste regulations.

Packaging materials must be separated and disposed of properly.

For user instructions in other languages,
please scan this code





GB: Warnings!

Please retighten the screws after 4-5 weeks of use, and then subsequently every 4-5 month.

Please do not tighten the nut with the maximum force. If it's tightened too much, the wooden frame might take damage.

DK: Advarsler!

Skruerne skal strammes igen efter 4-5 ugers brug og derefter hver 4-5. måned.

Du må ikke stramme møtrikken med maksimal kraft. Hvis den strammes for hårdt, kan trærammen tage skade.

DE: Warnungen!

Bitte ziehen Sie die Schrauben nach 4-5 Wochen Gebrauch wieder an, danach alle 4-5 Monate.

Bitte ziehen Sie die Mutter nicht mit der maximalen Kraft an. Wenn es zu stark angezogen ist, könnte der Holzrahmen beschädigt werden.

NO: Advarsler!

Fest skruene igjen etter 4-5 ukers bruk, og deretter hver 4-5 måned.

Ikke stram mutteren med maksimal kraft. Hvis den strammes for mye, kan trerammen ta skade.

SE: Varningar!

Dra åt skruvarna efter 4-5 veckors användning och därefter var 4-5:e månad.

Dra inte åt muttern med maximal kraft. Om den dras åt för hårt kan trärammen skadas.

NL: Waarschuwingen!

Draai de schroeven opnieuw aan na 4-5 weken gebruik, en vervolgens elke 4-5 maanden.

Draai de moer niet aan met de maximale kracht. Als het te strak wordt aangedraaid, kan het houten frame beschadigd raken.

FR: Des avertissements!

Veillez resserrer les vis après 4-5 semaines d'utilisation, puis tous les 4-5 mois.

Veillez ne pas serrer l'écrou avec la force maximale. S'il est trop serré, le cadre en bois pourrait être endommagé.

ES: Advertencias!

Por favor, apriete los tornillos después de 4-5 semanas de uso, y después veinte cada 4-5 meses.

Por favor, no apriete la tuerca con la máxima fuerza. Si se aprieta mucho, el marco de madera podría sufrir daños.



GB: Use of the product

This seating furniture is tested and passed the test specification according to EN 16139: 2013 Furniture – Strength, durability and safety – Requirements for non-domestic seating, Level 1 General use. Tested for 110 kg. per seat.

DK: Anvendelse af produktet

Dette sidde møbel er testet og har bestået testspecifikationen i henhold til EN 16139: 2013 Møbler - Styrke, holdbarhed og sikkerhed - Krav til siddepladser til erhvervsmæssig brug, niveau 1 Almindelig brug. Testet til 110 kg. pr. sæde.

DE: Verwendung des Erzeugnisses

Diese Sitzmöbel sind geprüft und bestanden die Prüfspezifikation nach EN 16139: 2013 Möbel – Festigkeit, Langlebigkeit und Sicherheit – Anforderungen an nicht-häusliche Sitzgelegenheiten, Level 1 Allgemeine Nutzung. Getestet für 110 kg. pro Sitzplatz.

NO: Bruk av produktet

Disse sittemøbler er testet og bestått testspesifikasjonen i henhold til EN 16139: 2013 Møbler - Styrke, holdbarhet og sikkerhet - Krav til ikke-hjemmesitteplasser, Nivå 1 Generell bruk. Testet for 110 kg. per sete.

SE: Användning av produkten

Denna sittmöbel har testats och klarat testspecifikationen enligt EN 16139: 2013 Möbler - Styrka, hållbarhet och säkerhet - Krav för sittplatser för icke-hushåll, nivå 1 allmän användning. Testad för 110 kg per plats.

NL: Gebruik van het product

Dit zitmeubilair is getest en voldoet aan de testspecificatie volgens EN 16139: 2013 Meubelen - Sterkte, duurzaamheid en veiligheid - Eisen voor zitplaatsen voor niet-huishoudelijk gebruik, niveau 1 Algemeen gebruik. Getest op 110 kg. per stoel.

FR: Utilisation du produit

Ce mobilier de siège est testé et passé la spécification de test selon EN 16139: 2013 Meubles – Résistance, durabilité et sécurité – Exigences pour sièges non-domestiques, Niveau 1 Usage général. Testé pour 110 kg. par siège.

ES: Uso del producto

Este mueble de asientos se prueba y pasa la especificación de prueba según EN 16139: 2013 Muebles – Resistencia, durabilidad y seguridad – Requisitos para asientos no domésticos, Nivel 1 Uso general. Probado para 110 kg. por asiento.

Tools overview

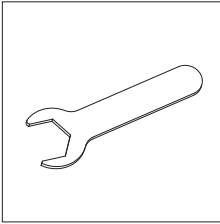

Fittings and product parts

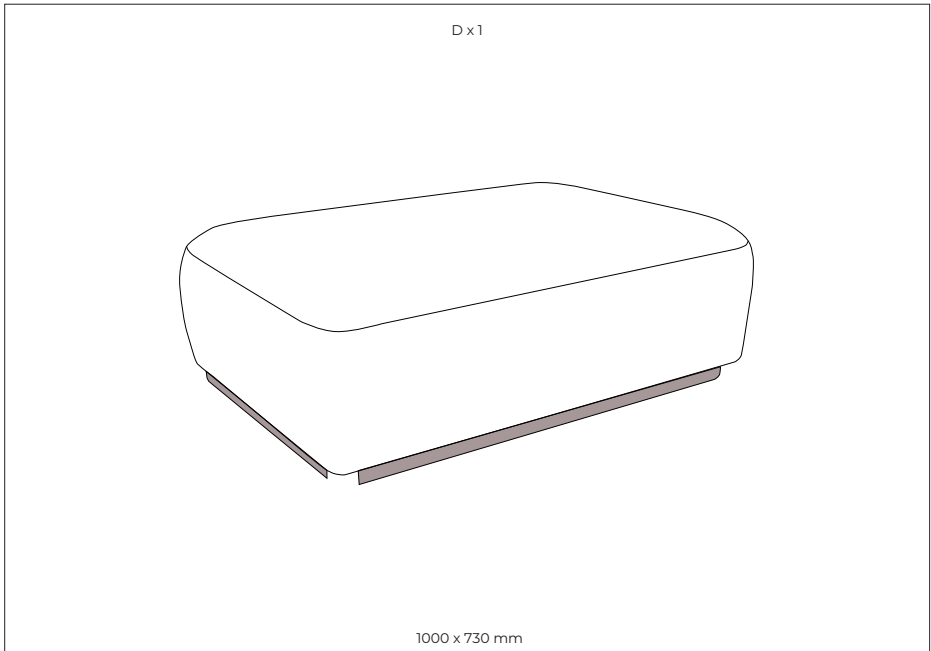
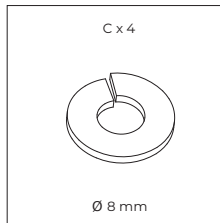
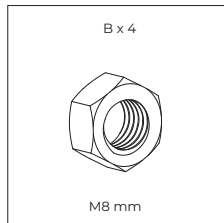
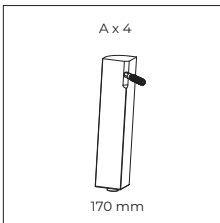

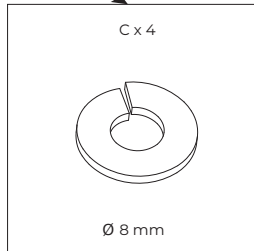
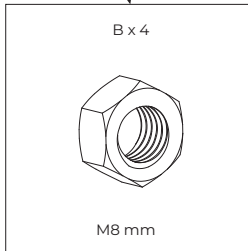
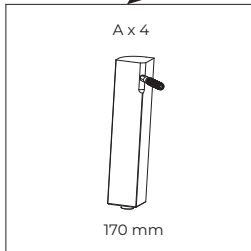
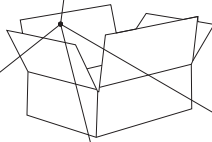
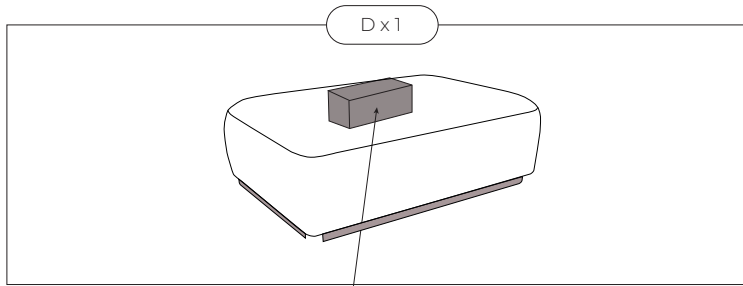

STEP 01

Tools & Special requirements

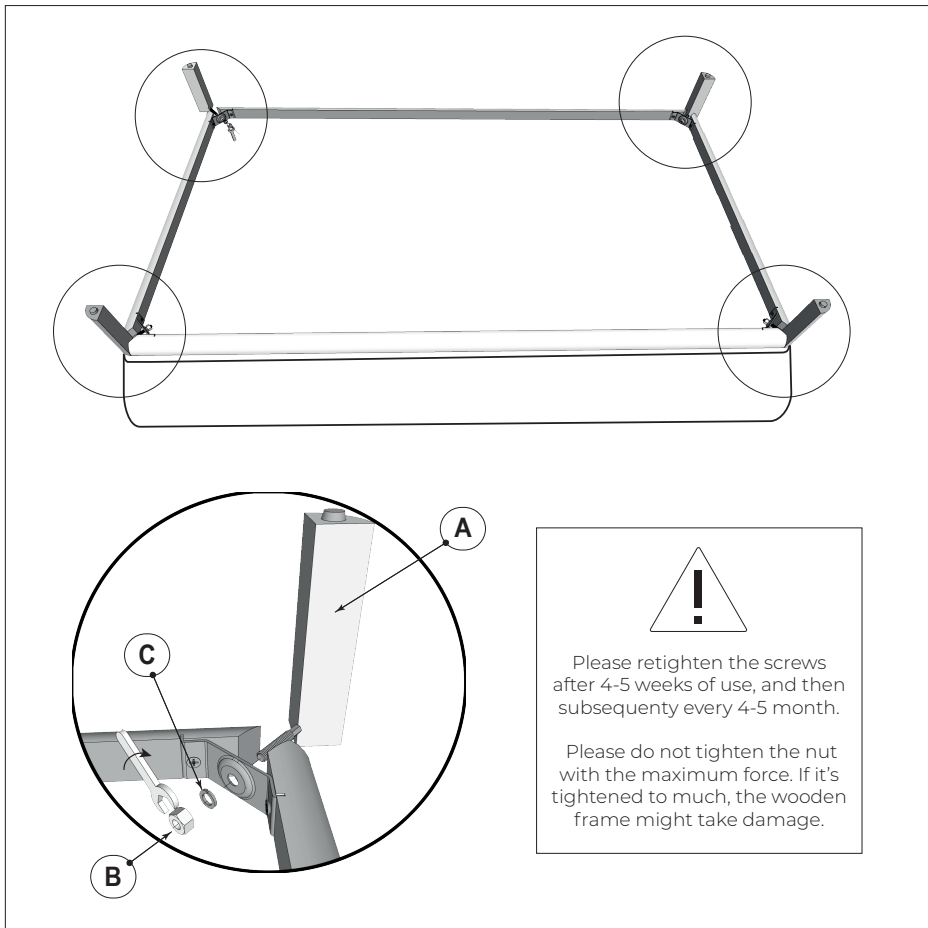
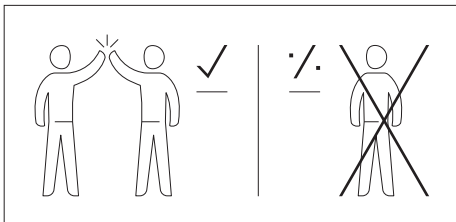
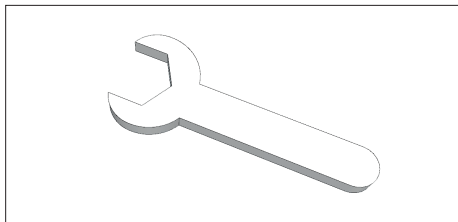



Please retighten the screws after 4-5 weeks of use, and then subsequently every 4-5 month.

Please do not tighten the nut with the maximum force. If it's tightened to much, the wooden frame might take damage.

Max
110 kg
242 lb



The diagram shows a white rectangular ottoman with four dark brown legs. Above the ottoman, a weight limit sign is displayed. The sign is a trapezoid with a handle at the top, containing the text 'Max', '110 kg', and '242 lb'. Below the sign, two downward-pointing arrows are positioned above a short horizontal line, indicating the weight is applied to the surface of the ottoman.

