



CARE INSTRUCTIONS

Brush off dust with a soft brush, or use a vacuum cleaner with a brush. Wipe with a damp cloth soaked in warm water and mild detergent. Use only a soft cloth, never sponges or steel wool. Do not use abrasive household cleaners. Do not use acidic or alkaline cleaning materials, glass cleaner or household ammonia.



GUBI A/S

FOR MORE INFORMATION

GUBI.COM

GUBI

MAINTENANCE INSTRUCTIONS

for

BESTLITE LAMPS

Replacing Acetate

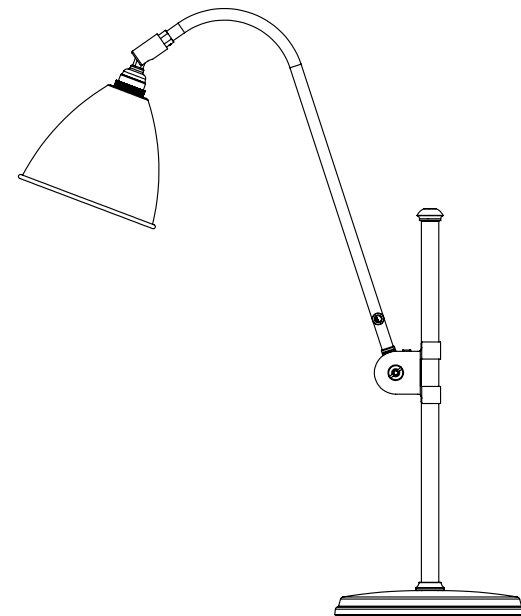

1. Screw the top off.

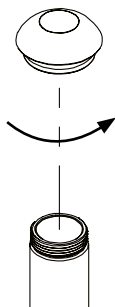

2. Use the Bestlite Key to loosen the nut.

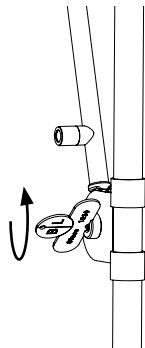

3. Slide the arm off the pole.

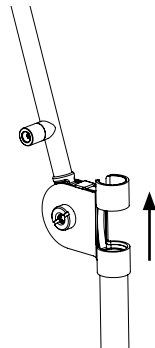

8. Remove and discard the acetate part.

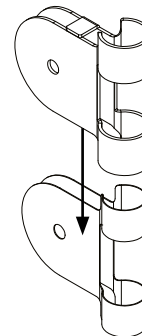

9. Replace the new acetate part.

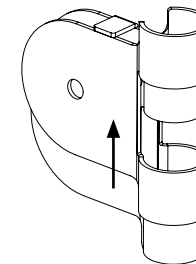

10. Place the discs onto the arm piece.

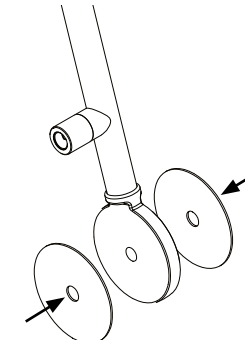

4. Remove the column brake.

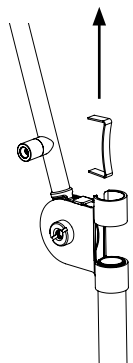

5. Un-screw the arm piece.

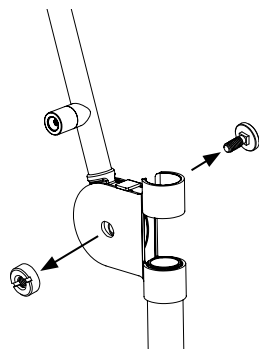

6. Remove the arm piece from the bracket.

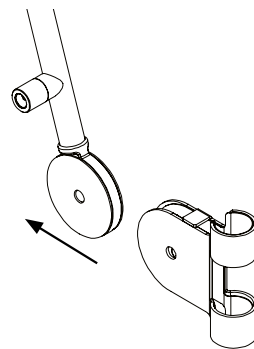

11. Slide the arm piece and discs into the bracket, inside the acetate part.

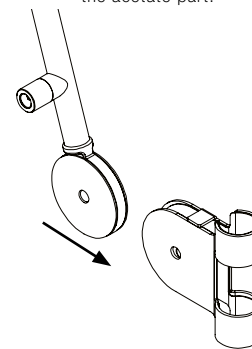

12. Mount the screws.

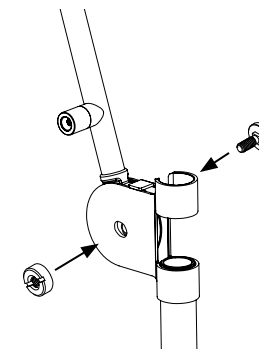

13. Insert the column brake.

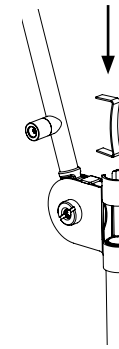

7. Remove the discs.

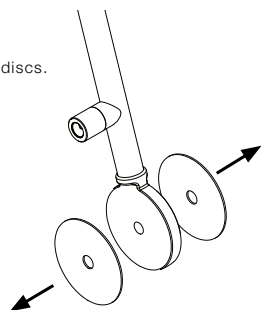

14. Slide the bracket and arm onto the pole.

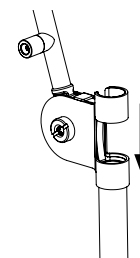

15. Tighten with the Bestlite Key.

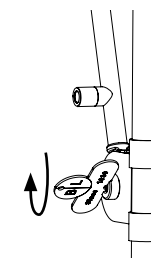

16. Screw in the top cap.

